

453 < Built-in wall louvres



*Wall louvre, heavy-duty series,
with aluminium coil blades, pitch 65*

Material

- Frame made from aluminium sections: AlMgSi 0.5 (according to EN 12020-2)
- Roll-formed aluminium coil blades
- Stainless steel 304 mesh (6 x 6 mm) or insect screen (2.3 x 2.3 mm) on request
- Finishing: powder-coated in any RAL or Syntha Pulvin colour (40 micron)

Dimensions

- Blade pitch: 65 mm
- Depth to fit: 60 mm
- Flange size: 25 mm
- Minimum dimensions: 300 x 300 mm

Fixing

- Brackets ref. 429
- For louvres larger than approx. 3 m², a reinforcing mullion is required to suit span and windload

Options

- Water channel
- Drainage profile
- Filter
- Without flange

Typical applications

- Aesthetical

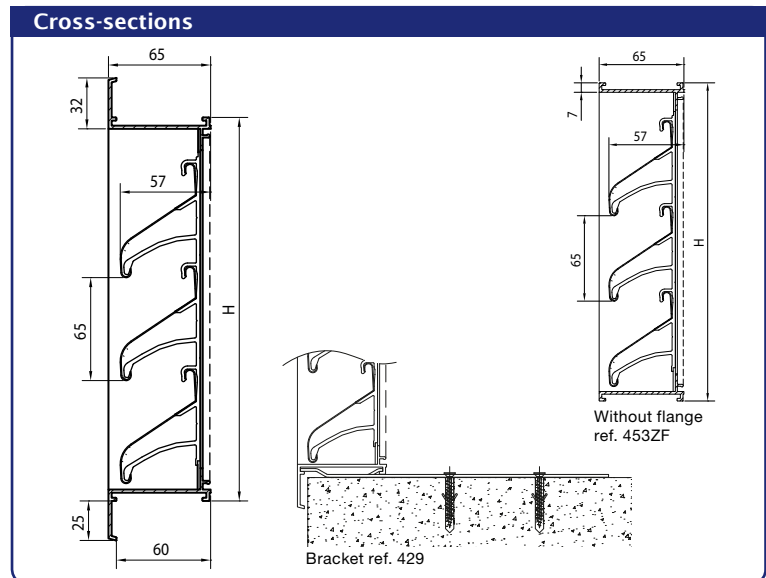

Technical specifications	
	453
Airflow	(EN 13030)
K-factor (supply)	13,32
K-factor (discharge)	17,08
C _e coefficient	0,274
C _d coefficient	0,242
Technical data	
Visual free area	69 %
Physical free area	55 %